

AIR COOLER

Midea

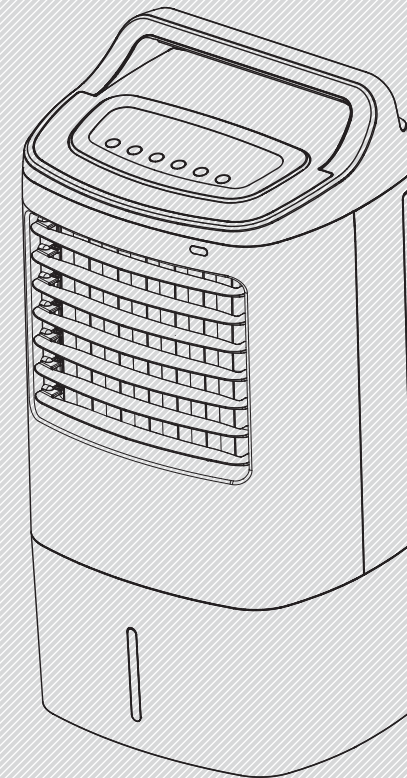

## OWNER'S MANUAL

10L AIR COOLER

MODEL:AC120-16AR

***READ AND SAVE THESE INSTRUCTIONS***

Attention: Pictures in the IM are for reference only.

**GD Midea Environment Appliances MFG.Co.,Ltd.**  
No.28, Dong Fu Road, Hesui East Industrial Area, Dong Feng Town,  
Zhongshan, Guangdong 528425 P.R.China

## SAFETY INSTRUCTION

1. Non-specialized personnel or unauthorized repair personnel shall not to repair or modify the machine.
2. It is forbidden to operate with wet hands to avoid electric shock.
3. Any power cord, which suffers from aging and knotting and whose plug is damaged, should be stopped its use immediately, and must be repaired by a professional manufacturer or equally qualified personnel.
4. No cleaning, maintenance or movement of the unit is allowed if it does not switch off.
5. If the unit is not in use for a long time, unplug the power cord.
6. To prevent accidental injury or damage to the unit, please do not insert any foreign matter into the air inlet and outlet, because the unit incorporates a high-speed wind rotor,
7. It is prohibited to use this unit in environments with flammable and explosive gases and direct sunlight for a long period shall be avoided.
8. Do not place this unit in an inclined or other uneven place to prevent the unit from falling and causing damage to the unit or internal parts.
9. This machine is suitable for indoor use instead of outdoor use.
10. This machine has a safety switch. If the honeycomb filter support has not been installed well, the unit will not work as usual; when the machine is working, do not remove the honeycomb filter frame.
11. At any time the water level in the tank shall not exceed "MAX" (maximum) scale, and during humidification, the total water level in the tank shall be controlled, and shall not be below "MIN" (minimum) scale.
12. After the water tank is filled with water, do not tilt or collide with the unit when placing or moving it. To move the unit body, please drive it slowly from the side to prevent water overflow.
13. In using the unit, prohibit overturning to avoid any accident. If the unit topples over accidentally, and it contains water, unplug the power cord immediately and take it to repair store.
14. Do not place items on the unit, and covering the outlet is strictly prohibited.

15. When wash the unit appearance, apply a damp cloth (or add a little cleaning agent) to wipe, and never use corrosive cleaning agent or solvent for cleaning. Never rinse the unit with water.
16. Do not have the air inlet and outlet of the unit close to walls, curtains and other objects, or they may block the airflow and affect air supply.
17. When the unit is running, do not knock at or shock the unit body forcibly or it may lead to automatic shutdown, in which case simply restart the unit.
18. In summer, the water in the tank may easily deteriorate and generate odor, please pay attention to regular change of water; if the indoor temperature is below zero in winter humidification, it is best to use warm water for humidification.
19. Do not place the unit directly below the power outlet.
20. Do not use the unit around the tub, sprinkler or swimming pool.
21. Product repair must be carried out in a designated agency.
22. If the supply cord is damaged, it must be replaced by manufacturer or its service agent or a similarly qualified person in order to avoid a hazard.
23. Indoor use only.
24. To protect against the risk of electrical shock, do not immerse the unit, cord or plug in water or other liquid.
25. This appliance is not intended for use by persons (including children) with reduced physical, sensory or mental capabilities, or lack of experience and knowledge, unless they have been given supervision or instruction concerning use of the appliance by a person responsible for their safety. Young children should be supervised to ensure that they do not play with the appliance.
26. When the appliance is not in use and before cleaning, unplug the appliance from the outlet.
27. Keep electrical appliances out of reach from Children or infirm persons. Do not let them use the appliances without supervision.
28. Unplug the appliance during filling and cleaning.
29. Prior to cleaning or other maintenance, the appliance must be disconnected from the supply mains.
30. Use a soft cloth moisten with mild soap, and then use a dry cloth to wipe it again.

31.	Correct Disposal of this product
	<p>This marking indicates that this product should not be disposed with other household wastes throughout the EU. To prevent possible harm to the environment or human health from uncontrolled waste disposal, recycle it responsibly to promote the sustainable reuse of material resources. To return your used device, please use the return and collection systems or contact the retailer where the product was purchased. They can take this product for environmental safe recycling.</p>

## INSTALLATION INSTRUCTIONS

### ■ Name of components

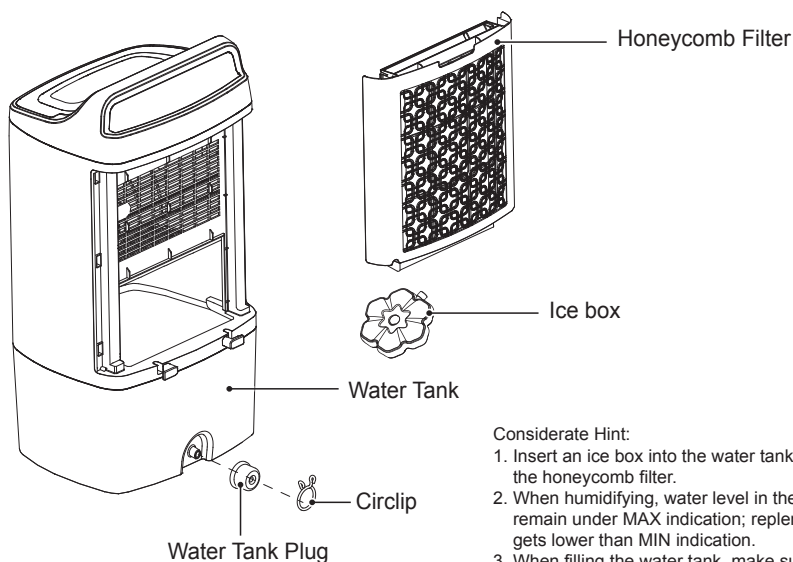

#### Considerate Hint:

1. Insert an ice box into the water tank before installing the honeycomb filter.
2. When humidifying, water level in the Water Tank must remain under MAX indication; replenish water if level gets lower than MIN indication.
3. When filling the water tank, make sure that the stopper and spring are properly positioned.

#### Foot-Wheel Installation

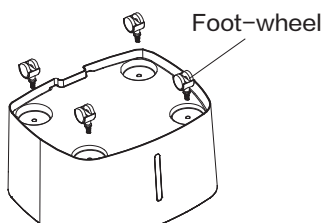

#### Removing the honeycomb filter

Gently pull out the honeycomb filter from the stand to remove it.

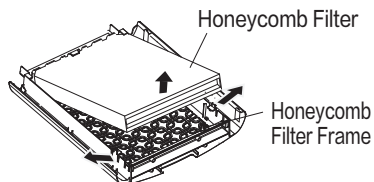

## INSTRUCTIONS FOR USE

### ■ Instructions for key of remote controller



### Battery Installation

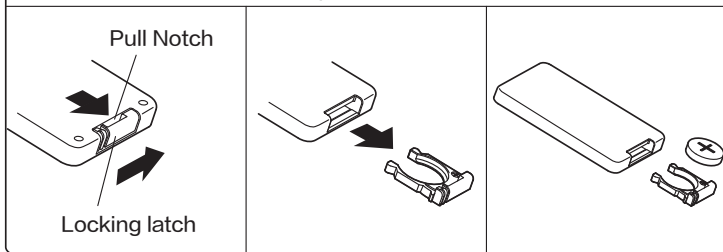

Considerate Hint:

1. Install the battery with positive side facing up.
2. Effective Range of Remote Control: within 5m distance and 30-degree deflection in front of Product.

## ■ Instructions for operation of body

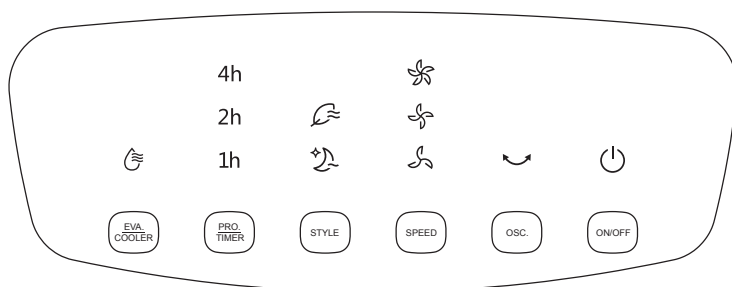

Press a key on the unit to activate a corresponding function.

For instance:

- Press [SPEED] Key to adjust 3 speeds of air flow.
- Press [STYLE] Key to switch between Natural and Sleep Functions.
- Press [PRO./TIMER] Key: When the fan is on, press the “PRO./TIMER” key to time the fan to shut down after 1–7 hours. In stand-by mode, you can pre-set the fan to start in 1–7 hours.
- When [EVA./COOLER] Key is pressed, the indicator lights up constantly if the operation is normal; when the indicator flashes, it denotes a water shortage, please add water immediately.

### **Please note:**

Push Buttons on the unit may differ based on the actual product model.

## **TROUBLESHOOTING**

In case the product cannot be operated normally after installation, checks shall be made for items described bellow:

1. Power cable unplugged or faulty contact.
2. Honeycomb filter assembly not properly installed.
3. Power Switch on the back of product or in the display panel not switched on.

If product remains dysfunctional after checking, a local dealer shall be sought for assistance.

## MAINTENANCE



Make sure power supply is disconnected before cleaning the product.



Never wash the unit in water. For cleaning, remove components (water tank, honeycomb filter, etc.) and clean them with water and soft brush. Allow them to air-dry before re-assembling.



Never clean the product with any abrasive tool or solvent. Clean with detergent and wipe dry with cloth immediately.



Never dismantle the product or attempt to make any modification. Regular check and cleaning of the product is recommended for prolonging its lifespan.